



Wick Lane, London, E3

BUTLER & STAG



**Guide Price - £600,000 to £650,000**

**Welcome to this spacious and elegant three-bedroom, two-bathroom apartment, perfectly located on Wick Lane. Offering a blend of comfort, luxury, and convenience, this stunning residence boasts breathtaking views of the River Lea and the iconic Olympic Park from a vast private balcony.**



## Leasehold

- Three Bedrooms
- Two Bathrooms
- Spanning Over 1150 Sq. Ft
- Two Private Balconies
- Stunning Canal & Olympic Park Views
- Concierge Service
- Private Underground Parking
- Lift Access
- EWS1 Compliant
- Ample Storage Throughout

### Key Features:

**Generous Living Space:** A bright and open-plan living/dining area that seamlessly connects to the expansive balcony, perfect for entertaining or relaxing.

**Three Bedrooms and Two Modern Bathrooms,** Fully equipped with contemporary fittings.

**Huge Balcony:** Enjoy panoramic views of the River Lea and the Olympic Park, providing a tranquil retreat amidst urban vibrancy.

**Secure Underground Parking:** Benefit from your own allocated parking space for added convenience and security.

**Concierge Service:** On-site concierge to assist with your needs and ensure peace of mind.

**Located in the heart of East London,** this home offers excellent transport links, easy access to local amenities, and proximity to the vibrant Hackney Wick and Stratford areas. Don't miss the chance to live in one of the most desirable settings in the city.



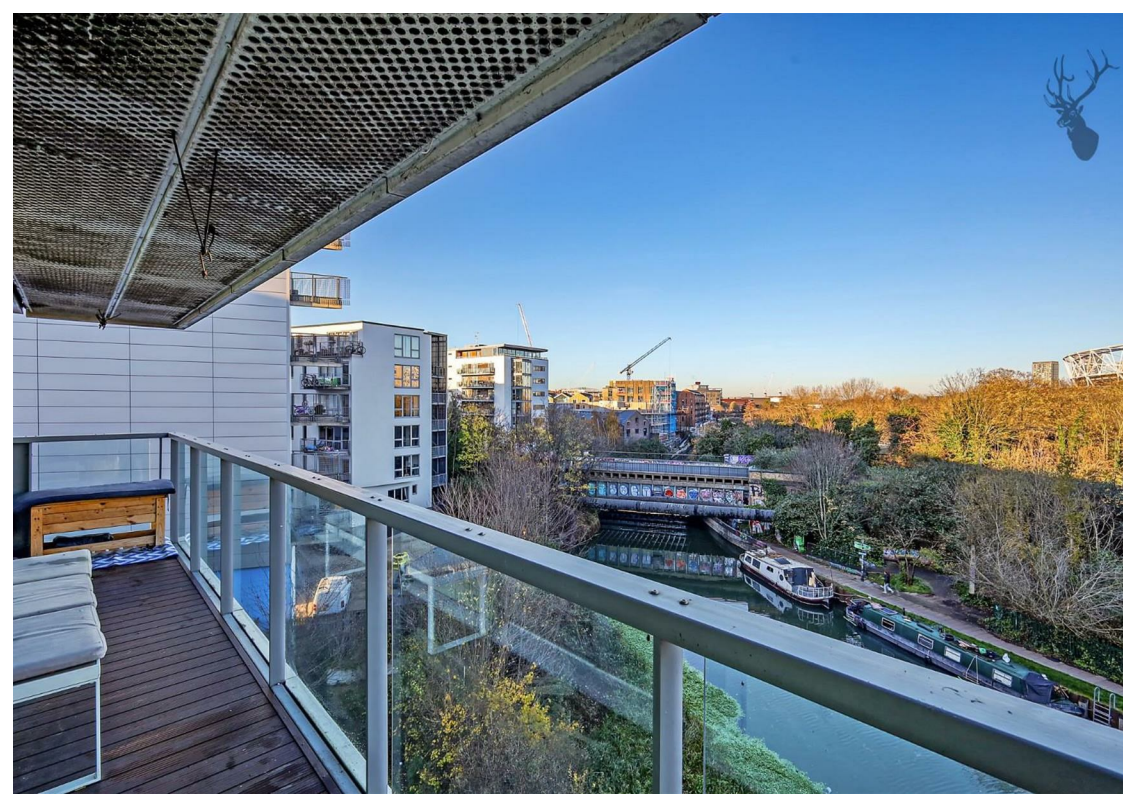

# Ink Court

Approx. Gross Internal Area 107.1 sq. metres (1153.2 sq. feet)



**Third Floor**  
Approx. 107.1 sq. metres (1153.2 sq. feet)



Measurements are approximate and for illustration purposes only. While we do not doubt the accuracy and completeness, we advise you conduct a careful independent assessment of the property to determine monetary value  
© @modephotouk www.modephoto.co.uk



☎ 020 8102 1236

🏠 508 Roman Road, Bow, London, E3 5LU

✉ bow@butlerandstag.com

[www.butlerandstag.uk](http://www.butlerandstag.uk)

IMPORTANT NOTICE - These particulars have been prepared in good faith and they are not intended to constitute part of an offer or contract. We have not performed a structural survey on this property and the services, appliances and specific fittings have not been tested. All photographs, measurements, floor plans and distances referred to are given as a guide and should not be relied upon.